

**Overview of Testing Results for Lead in Drinking Water  
and Corrective Actions for  
Naval Air Station Oceana All sports Zone Youth Center (Building 531)**

The Navy is committed to maintaining safe drinking water on its installations. City water supplied to the Navy and the Navy's water distribution system is regularly tested and in compliance with the Safe Drinking Water Act. Because lead exposure is a particular concern for children, and lead may be added to drinking water through the pipes, fittings, solder, and fixtures inside a building, the Environmental Protection Agency (EPA) recommends, but does not mandate, that we test the lead content of drinking water in priority areas such as youth centers (YCs), child development group homes (CDGHs), and child development centers (CDCs). The Navy has adopted the recommendation as policy.

Navy environmental personnel conducted lead testing at the Naval Air Station (NAS) Oceana All Sports Zone Youth Center (YC) Building 531, in accordance with Navy and EPA guidelines. Samples from various locations in the YC Building 531 were sent to a state-certified laboratory for analysis.

At the YC Building 531, outlets used for drinking, cooking/ food preparation, and washing were tested. Out of 18 samples collected, two water outlets initially tested above the EPA-recommended screening level for lead in drinking water in schools and childcare centers of 15 parts per billion (ppb).

The aerators on these faucets were cleaned and the system was flushed. Resampling of these outlets confirmed that lead levels are indeed below the screening level of 15ppb and that the prior exceedance was due to the faucet aerators.

A copy of all test results is enclosed for your information. The test results are presented in two tables:

- Table 1 **Summary of Results** summarizes the data by category of use (e.g., drinking, cooking, washing).
- Table 2 **Summary Statistics** summarizes all the data.

A floor plan of the YC Building 531 has also been included to show the locations of the fixtures.

**Table 1** provides a description of each sampling location using three columns; *Category*, *Sampling ID*, and *Outlet Description*. The *Category* column gives information about whether the outlet is used for drinking water (water fountain), cooking (food preparation), or washing (primarily hand-washing or brushing teeth). The *Sample ID* column is the identification used to label each sample bottle. The *Outlet Description* column contains additional information to describe the outlet sampled under each category.

The next set of columns in **Table 1** provide *Initial Sampling Results*, and for those locations that exceeded the recommended screening level of 15 ppb the *Re-sampling Results*.

EPA sampling protocol requires water to not be used for between 8 and 18 hours prior to first draw sampling. Therefore, *Initial Sampling Results* were from first draw samples collected early in the morning before the YC opened and before any water was used. The *Initial Sampling Results* also indicate whether resampling is required and the date that fixtures greater than 15 ppb were secured. Two of the sampled outlets exceeded 15 ppb.

The *Re-sampling Results* includes columns for *First Draw* and flushing samples which help determine the source of lead for sampled outlets that exceeded 15 ppb.

To learn more about lead in drinking water in schools and day care centers visit the following EPA website: <https://www.epa.gov/dwreginfo/lead-drinking-water-schools-and-child-care-facilities>.

To learn more about annual water quality at your home, see the annual water quality report at: [https://www.cnic.navy.mil/regions/cnrma/om/environmental\\_support/water\\_quality\\_information.html](https://www.cnic.navy.mil/regions/cnrma/om/environmental_support/water_quality_information.html)

Another resource on drinking water taste, odor, and color can be found at: <https://www.epa.gov/dwstandardsregulations/secondary-drinking-water-standards-guidance- nuisance-chemicals>

To answer general questions you may have on the sampling program contact us at (757) 433-3155 or [jennifer.hayes@navy.mil](mailto:jennifer.hayes@navy.mil).

If you have any health questions or concerns, you are encouraged to contact your health care provider or, if you are a TRICARE beneficiary, use the Region Appointment Center to schedule an appointment with your primary care provider at 1-866-645-4584.

Enclosures:

1. Complete Test Results
2. Floor Plan of the SAC/YC

Priority Areas Lead Testing and Corrective Actions (June 2019)  
 MAS Oceana, SAC Youth Center Sports Zone, Building 531

Table 1. Summary of Results

CATEGORY Water Intended For:	SAMPLING LOCATION DESCRIPTION		INITIAL SAMPLING RESULTS		RE-SAMPLING RESULTS		CORRECTIVE ACTIONS		POST REMEDIATION SAMPLING RESULTS		
	SAMPLE ID	SAMPLE ID	Outlet Description	First Draw (ppb)	Date Facility Secured/ Required?	Water Fountain Follows up Flush 15 min. Follow up Flush Sample - Collected dry before First Draw Sampling (ppb)	First Draw (ppb)	Follow up Flush - Collected 30 seconds after First Draw Sampling (ppb)	Description	First Draw (ppb)	Recommended Level = 15 ppb
DRINKING				6/12/2019			7/19/2019	7/19/2019		N/A	N/A
DRINKING	OC-531-BATH-NRWA-FD	1	High hand washing faucet	7/2/2019	No	0	N/A	0		N/A	N/A
DRINKING	OC-531-BATH-NRWA-FD	2	High hand washing faucet	7/2/2019	No	0	N/A	0		N/A	N/A
DRINKING	OC-531-BATH-NRWA-FD	3	High hand washing faucet	7/2/2019	No	0	N/A	0		N/A	N/A
DRINKING	OC-531-BATH-NRWA-FD	4	High hand washing faucet	7/2/2019	No	0	N/A	0		N/A	N/A
DRINKING	OC-531-BATH-NRWA-FD	5	High hand washing faucet	7/2/2019	No	0	N/A	0		N/A	N/A
DRINKING	OC-531-BATH-NRWA-FD	6	High hand washing faucet	7/2/2019	No	0	N/A	0		N/A	N/A
DRINKING	OC-531-BATH-NRWA-FD	7	High hand washing faucet	7/2/2019	No	0	N/A	0		N/A	N/A
DRINKING	OC-531-BATH-NRWA-FD	8	High hand washing faucet	7/2/2019	No	0	N/A	0		N/A	N/A
DRINKING	OC-531-BATH-NRWA-FD	9	High hand washing faucet	7/2/2019	No	0	N/A	0		N/A	N/A
DRINKING	OC-531-BATH-NRWA-FD	10	High hand washing faucet	7/2/2019	No	0	N/A	0		N/A	N/A
DRINKING	OC-531-BATH-NRWA-FD	11	High hand washing faucet	7/2/2019	No	0	N/A	0		N/A	N/A
DRINKING	OC-531-BATH-NRWA-FD	12	High hand washing faucet	7/2/2019	No	0	N/A	0		N/A	N/A
DRINKING	OC-531-BATH-NRWA-FD	13	High hand washing faucet	7/2/2019	No	0	N/A	0		N/A	N/A
DRINKING	OC-531-BATH-NRWA-FD	14	High hand washing faucet	7/2/2019	No	0	N/A	0		N/A	N/A
DRINKING	OC-531-BATH-NRWA-FD	15	High hand washing faucet	7/2/2019	No	0	N/A	0		N/A	N/A
DRINKING	OC-531-BATH-NRWA-FD	16	High hand washing faucet	7/2/2019	No	0	N/A	0		N/A	N/A
DRINKING	OC-531-BATH-NRWA-FD	17	High hand washing faucet	7/2/2019	No	0	N/A	0		N/A	N/A
DRINKING	OC-531-BATH-NRWA-FD	18	High hand washing faucet	7/2/2019	No	0	N/A	0		N/A	N/A
DRINKING	OC-531-BATH-NRWA-FD	19	High hand washing faucet	7/2/2019	No	0	N/A	0		N/A	N/A
DRINKING	OC-531-BATH-NRWA-FD	20	High hand washing faucet	7/2/2019	No	0	N/A	0		N/A	N/A
DRINKING	OC-531-BATH-NRWA-FD	21	High hand washing faucet	7/2/2019	No	0	N/A	0		N/A	N/A
DRINKING	OC-531-BATH-NRWA-FD	22	High hand washing faucet	7/2/2019	No	0	N/A	0		N/A	N/A
DRINKING	OC-531-BATH-NRWA-FD	23	High hand washing faucet	7/2/2019	No	0	N/A	0		N/A	N/A
DRINKING	OC-531-BATH-NRWA-FD	24	High hand washing faucet	7/2/2019	No	0	N/A	0		N/A	N/A
DRINKING	OC-531-BATH-NRWA-FD	25	High hand washing faucet	7/2/2019	No	0	N/A	0		N/A	N/A

Notes:  
 \* Affected outlets were immediately secured after receiving verbal communication from the lab on results; exceeding the recommended level of 15 ppb.  
 \* Resampling was conducted on 7/19/2019 after removing and cleaning the aerator of affected outlets. The resample results were below recommended level of 15 ppb as shown on Table 1.

Table 2. Summary Statistics

CATEGORY	INITIAL SAMPLING RESULTS		RE-SAMPLING RESULTS		POST REMEDIATION RESULTS	
	First Draw	Water Fountain Follows up Flush Sample - Collected dry before First Draw Sampling	First Draw (ppb)	Follow up Flush - Collected 30 seconds after First Draw Sampling	First Draw	Follow up Flush - Collected 30 seconds after First Draw Sampling
Total Drinking	0	0	0	0	0	0
Total Drinking > 15 ppb	0	0	0	0	0	0
Total Cooling	1	0	0	0	0	0
Total Cooling > 15 ppb	0	0	0	0	0	0
Total Washing	13	0	2	2	0	0
Total Washing > 15 ppb	2	0	0	0	0	0
Total Samples	18	0	2	2	0	0
Total Samples > 15 ppb	2	0	0	0	0	0

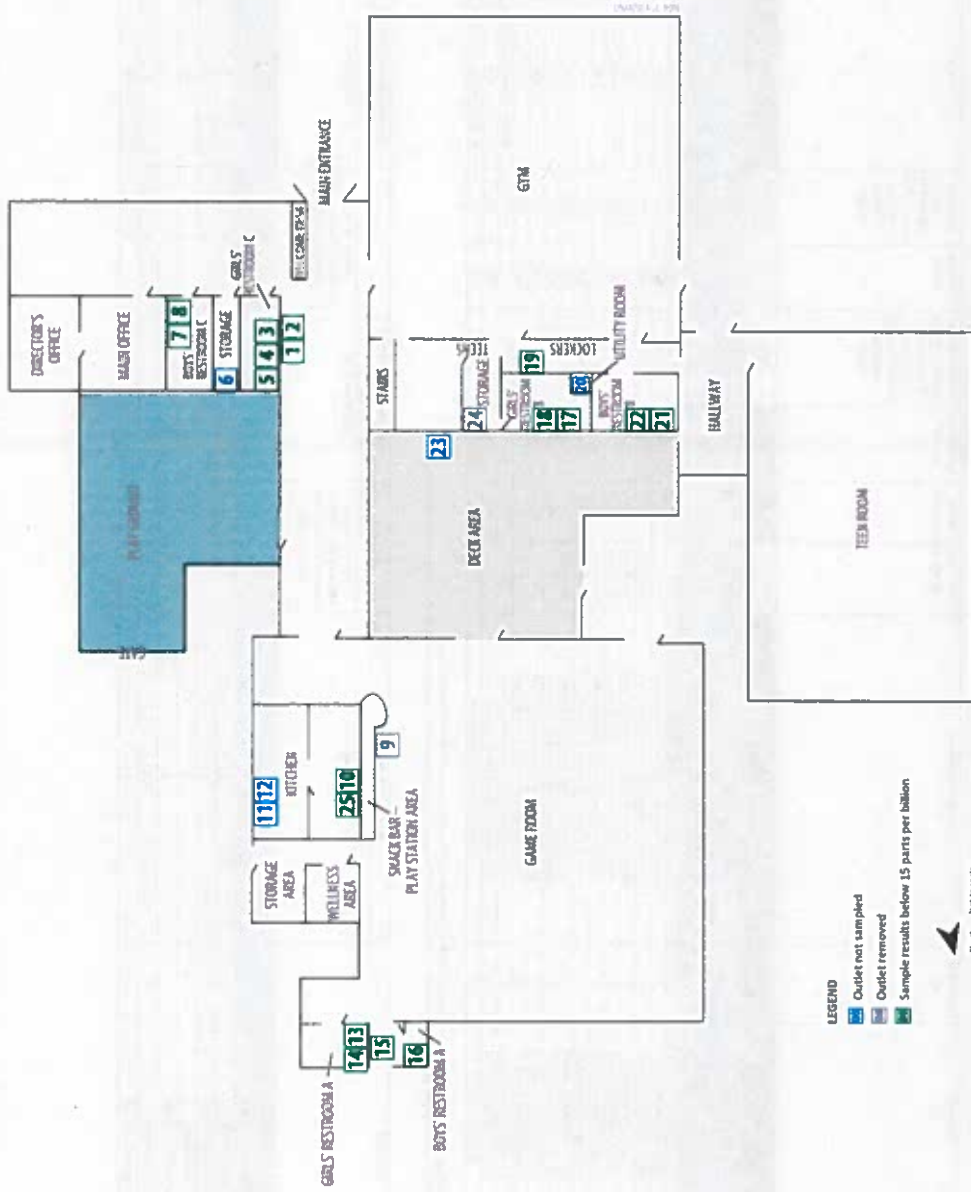

**Building 531 - First Floor Plan**  
 NAS Oceana  
 Virginia Beach, Virginia

**ch2m:**

Enclosure (2)

**LEGEND**  
  Outlet not sampled  
  Outlet removed  
  Sample results below 15 parts per billion



No.	Type of Fixture	Location Description	Exceeded?
1	Water fountain (cooler)	Hallway	No
2	Water fountain (cooler)	Hallway	No
3	High hand washing faucet	Women's Restroom	No
4	High hand washing faucet	Women's Restroom	No
5	High hand washing faucet	Women's Restroom	No
6	Utility sink	Storage Room	Not sampled
7	High hand washing faucet	Men's Restroom	No
8	High hand washing faucet	Men's Restroom	No
9	Water fountain (cooler) - removed	Kitchen	Outlet removed and cannot be sampled
10	Kitchen sink for dishwashing, food preparation	Kitchen	No
11	Ice maker	Kitchen	Not sampled
12	Utility sink	Kitchen	Not sampled
13	High hand washing faucet	Girls' Restroom A	No
14	High hand washing faucet	Girls' Restroom A	No
15	Water fountain (cooler)	Hallway	No
16	High hand washing faucet	Boys' Restroom A	No
17	High hand washing faucet	Girls' Restroom B	No
18	High hand washing faucet	Girls' Restroom B	No
19	Water fountain (cooler)	Locker Room	No
20	Utility sink	Utility Room	Not sampled
21	High hand washing faucet	Boys' Restroom B	Results were below recommended level after aerator was cleaned
22	High hand washing faucet	Boys' Restroom B	No
23	Hose bib	Outside (deck area)	Not sampled
24	Portable sink that is not connected to the building plumbing – not for drinking. Outlet has been removed.	Science Room	Outlet removed and cannot be sampled
25	High hand washing faucet	Kitchen	Results were below recommended level after aerator was cleaned

